

	TEACHER GUIDE	
•	Assessment Rubric	4
•	How Is Our Resource Organized?	5
•	Bloom's Taxonomy for Reading Comprehension	6
•	Vocabulary	6
	STUDENT HANDOUTS	
•	Reading Comprehension – Five Themes of Geography	
	1. Location	7
	2. Place	11
	3. Human and Environmental Interactions	15
	4. Movement	20
	5. Regions	24
•	Crossword	29
•	Word Search	30
•	Comprehension Quiz	31
	EASY MARKING™ ANSWER KEY	33
	STUDENT BLACKLINE MAPS	37
	MINI POSTERS	49

FREE!

✓ **6 BONUS Activity Pages!** Additional worksheets for your students

- Go to our website: www.classroomcompletepress.com/bonus
- Enter item CC5755
- Enter pass code CC5755D



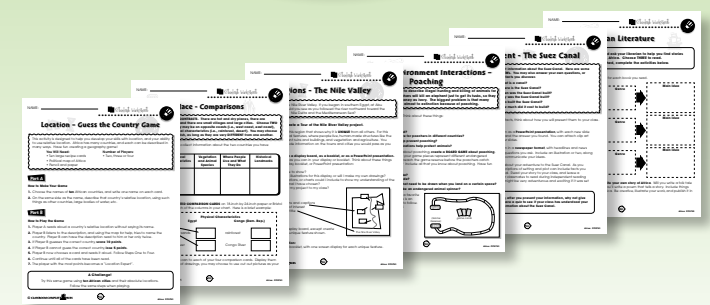

Human/Environment Interactions

1. People interact with their environment each day. Sometimes we do things that leave the environment unchanged. Sometimes we do things that harm the environment. Sometimes we do things that renew the environment. Sometimes we do things that protect the environment. Read each example below, and decide how it **affects** the environment. Color in the box that shows your answer.

	unchanged	harmful	renews	protects
a) recycling	<input type="checkbox"/>	<input type="checkbox"/>	<input type="checkbox"/>	<input type="checkbox"/>
b) littering	<input type="checkbox"/>	<input type="checkbox"/>	<input type="checkbox"/>	<input type="checkbox"/>
c) planting trees	<input type="checkbox"/>	<input type="checkbox"/>	<input type="checkbox"/>	<input type="checkbox"/>
d) hiking in the woods	<input type="checkbox"/>	<input type="checkbox"/>	<input type="checkbox"/>	<input type="checkbox"/>
e) using clean gasoline	<input type="checkbox"/>	<input type="checkbox"/>	<input type="checkbox"/>	<input type="checkbox"/>
f) creating wildlife sanctuaries	<input type="checkbox"/>	<input type="checkbox"/>	<input type="checkbox"/>	<input type="checkbox"/>
g) pouring chemicals down the drain	<input type="checkbox"/>	<input type="checkbox"/>	<input type="checkbox"/>	<input type="checkbox"/>
h) killing endangered animals	<input type="checkbox"/>	<input type="checkbox"/>	<input type="checkbox"/>	<input type="checkbox"/>

2. Choose **one** of the items in the above list and describe your answer in complete sentences. Explain why you chose the box that you did.



Human/Environment Interactions

Learning about how people affect the environment around them means learning about human and environmental **interactions**. There are many things that we do that affect our **environment**. We recycle paper to save trees, but sometimes we harm the habitats of animals with pollution. We work to protect **endangered** species, but some people continue to kill them. Sometimes we introduce a kind of animal or insect into a place where it did not live before, and this has a bad effect on the environment. When an environment is harsh or changing, we must often **adapt** to our environment to survive.



One famous human and environmental interaction in Australia occurred when some rabbits were brought from England and released into the wild. These rabbits had many babies, and they spread throughout the continent. Within a few **decades**, there were millions of rabbits in Australia because no animals were their natural enemies. The rabbits changed the landscape because they ate so much **vegetation** that winds and water blew and washed away the soil in many places. Rabbit holes and **warrens** were everywhere! They also became serious pests because they ate crops and the natural vegetation other animals needed to survive. Many scientists believe that some Australian **species** became **extinct** because of the rabbits and all the food they ate! There was not enough food left for them to eat!

STOP How did rabbits from England hurt Australia's environment?

The Great Barrier Reef in the Coral Sea is so **spectacular** that it is a World Heritage Site. That means that people have decided to protect it from destruction. It contains many rare kinds of fish, and a variety of turtles, sharks, and other unusual sea creatures. Australians work to protect the reef from damage caused by ships, too much fishing, and pollution. Their efforts have had a positive effect on the wildlife that lives on the coral reefs.



Human/Environment Interactions

1. Fill in the blank with a word from the list.

England interactions coral reef protect vegetation
extinct rabbits millions enemies decades

Many human and environmental _____ a _____ have occurred in Australia. One destructive interaction happened when _____ b _____ from _____ c _____ were introduced without any natural _____ d _____. Within a few _____ e _____ there were _____ f _____ of rabbits in Australia, eating as much _____ g _____ as they could! These rabbits have been blamed for causing some Australian species to become _____ h _____. The Great Barrier Reef is a _____ i _____ that has been named a World Heritage Site so people will take special care to _____ j _____ it from destruction.

2. Which word matches the definition? Color the arrow that points to the correct word. You may use either the reading or a dictionary to help find your answers.

warren	<input type="checkbox"/>	A The many tunnels and hiding places in a rabbit's home	<input type="checkbox"/>	decade
endangered	<input type="checkbox"/>	B The word used to describe a species that no longer exists	<input type="checkbox"/>	extinct
environment	<input type="checkbox"/>	C The land, air, and water in a particular area	<input type="checkbox"/>	species



Human/Environment Interactions

Answer each question with a complete sentence.

- What are some positive human and environmental interactions? (Re-read the first paragraph!)
- What are some negative human and environmental interactions? (Re-read the first paragraph!)

Research

- Using the Undersea Organizer on the next page, research and collect facts about the Great Barrier Reef. Look for information on the following topics:

characteristics size location
water temperature species human threats to it

Present your information to the class by sharing your organizer.

- What kinds of programs does your school, town, or city have that were chosen because they help protect the environment? (Circle) one of these areas to research.

my school my neighborhood my town my city

Complete a chart like the one below to help you collect your information. Share your chart with the class.

My _____'s Programs	How they help protect the environment



Australia's Regions Organizer

Use this organizer to record information about Australia's regions.

Territory: Queensland Name of Region: Physical Characteristics:	Territory: Western Australia Name of Region: Physical Characteristics:
Territory: New South Wales Name of Region: Physical Characteristics:	Territory: South Australia Name of Region: Physical Characteristics:
Territory: Northern Territory Name of Region: Physical Characteristics:	Territory: Tasmania Name of Region: Physical Characteristics:



Crossword Puzzle!

Word List

equator
 islands
 aboriginal
 negative
 extinct
 kangaroo
 movement
 unique
 south
 cross
 reef
 habitable
 absolute
 east
 remote
 outback

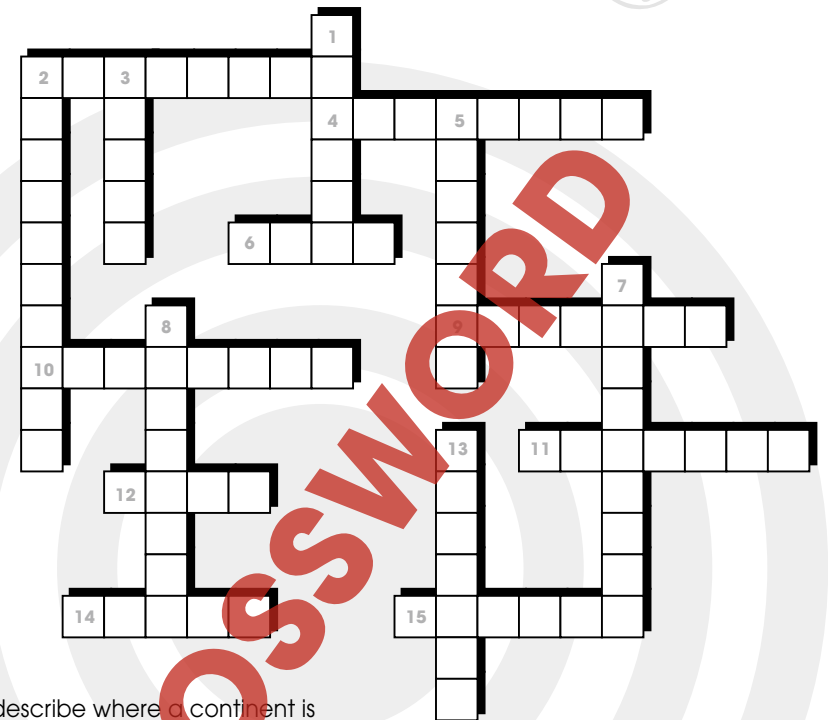

Across

- 2** It is difficult to describe where a continent is by using ____ location
4 ____ describes how people, products and ideas move from place to place.
6 The Great Barrier ____ is one of Australia's unique features
9 The damage caused by rabbits from England is an example of ____ interaction.
10 The damage caused by rabbits from England is an example of a ____ human
11 A species is ____ when it no longer exists
12 The Pacific Ocean is ____ of Australia
14 Absolute location is described by where the lines of latitude and longitude ____
15 A region is an area of land with ____ features

Down

- 1** Some areas of Australia are so ____ that highways are not even paved
2 Some of Australia's ____ peoples live in the Outback
3 Australia is ____ of the equator
5 Imaginary line running east-west around the middle of the Earth
7 Australia is the world's smallest ____ continent
8 An unusual example of Australian wildlife is the ____
13 Oceania is a group of many small ____ east and northeast of Australia



Comprehension Quiz

Part A



Circle the word TRUE if the statement is true. Circle the word FALSE if it's

- false.
TRUE FALSE a) Australia is in the southern hemisphere.
TRUE FALSE b) The Pacific Ocean is to the west of Australia.
TRUE FALSE c) Australia's Outback has many deserts.
TRUE FALSE d) Lake Eyre is below sea level.
TRUE FALSE e) There are no subways in Australia's cities.
TRUE FALSE f) Hobart is on the island of Tasmania.
TRUE FALSE g) Rabbits have helped the natural environment of Australia.
TRUE FALSE h) The word **rural** describes an area in the country or a remote area.



Part B

Label the map by doing the following:

1. Show the following features on the map by writing the letter on the map in the correct location.

- a) Indian Ocean
 b) Pacific Ocean
 c) Australia
 d) Tasmania
 e) New Guinea



2. Color the equator red.

SUBTOTAL: /14

Australia Physical Map





Australia - Location



Answer the questions in complete sentences.

3. Why is it difficult to describe a continent's **exact** location?

4. Which major bodies of water surround Australia?

Research and Applications

5. **New Zealand** is often included as a part of the continent of Australia. Find New Zealand on a map. Using the features around it, describe its **relative** location.

6. Many atlases list the exact locations of the world's major cities using latitude and longitude. Using an atlas, find the **exact** location of **ten Australian cities** of your choice. Also, list the country in which we find each city and the hemisphere(s) in which it is found. Make a chart like this to help you organize the information you find. One has been done for you.

City Name	Hemisphere (give two)	Exact Location	Country
Brisbane	southern and eastern	27°N latitude 153°E longitude	Australia

7. Think about the location of your school. What is its number, its street, its city, and its state? What things do you find around it?

Describe your school in **two** ways. Give its **exact** location. Give its **relative** location. How are the two descriptions the same? How are they different? Share your descriptions with a friend.

3. It is too vast to use latitude and longitude to pinpoint an exact location where these lines cross

4. Indian Ocean, Pacific Ocean, Coral Sea, etc.

5. Possible answers: east of Australia, north of Antarctica, Pacific Ocean, etc.

6. Answers will vary

7. Answers will vary

1. wildlife

X aboriginal people - D

X desert - E

X mountain - C

X coral reef - A

2. Answers will vary

Possible answers: deserts, mountains, coral reef off shore, rivers, etc.

1. a) B

b) A

c) D

a) Circle: wildlife, languages spoken, where people live, mountains, physical characteristics, valleys

b) Answers will vary

3. They developed on the coasts for trade and transportation

4. Deserts, mountains, coral reefs, etc.

5. Answers will vary

6. Possible species: **mammal:** kangaroo **bird:** emu **reptile:** goanna **fish:** butterflyfish **spider:** Australian lungless spider

EASY MARKING ANSWER KEY



12

13

14

