

	TEACHER GUIDE	
•	Assessment Rubric	4
•	How Is Our Resource Organized?	5
•	Bloom’s Taxonomy for Reading Comprehension	6
•	Vocabulary	6
	STUDENT HANDOUTS	
•	Reading Comprehension – Five Themes of Geography	
	1. Location	7
	2. Place	
	3. Human and Environmental Interactions	
	4. Movement	
	5. Regions	
•	Crossword	11
•	Word Search	12
•	Comprehension Quiz	13
	EASY MARKING™ ANSWER KEY	15
	STUDENT BLACKLINE MAPS & IMAGES	17
	MINI POSTERS	29

FREE!

✓ **6 BONUS Activity Pages!** Additional worksheets for your students

- Go to our website: www.classroomcompletepress.com/bonus
- Enter item CC5756
- Enter pass code CC5756D



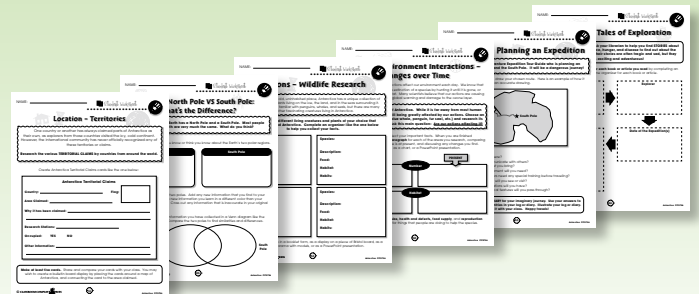

Antarctica - Location

1. Which word matches the definition? Color the arrow that points to the correct word. You may use an atlas or a dictionary to help.

island	←	A A large land mass. There are seven of these on Earth.	→	continent
longitude	←	B An imaginary line running around the middle of the Earth in an east-west direction. It is half way between the North and South Poles.	→	Equator
South Pole	←	C A word that is used to describe the southern end of the axis around which the Earth rotates.	→	South America
hemisphere	←	D One of the two shapes made by cutting a sphere in half.	→	latitude

2. On the map, color Antarctica in orange. Show the Equator as a red line, and the Prime Meridian as a green line.



Antarctica - Location

How can we describe where a place is located? We can describe *exactly* where a place is by giving its **absolute location**. We can do this by looking at where lines of **latitude** and **longitude** cross on a map. We might describe the things around it and the things that connect it to other places. This kind of description is called **relative location**.

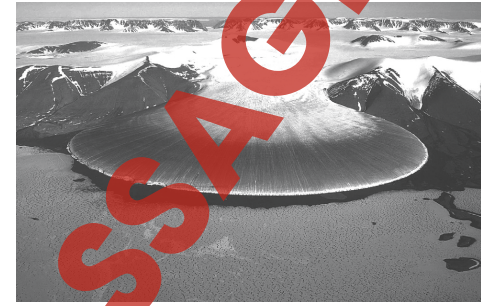

Antarctica is very easy to find on a map or on a globe. Just look for the **South Pole**! If we used latitude to describe its location, we could say that all of Antarctica is south of 60°S latitude. Would that be enough to describe exactly where it is? For some people it would be, but others might want to know more. For them, it would be better to describe Antarctica's relative location by looking at those features and places around it.

Antarctica's location makes it unique. It is like a large island at the South Pole. The pack ice that surrounds it often hides its real shape. Antarctica is in the southern **hemisphere**, far south of the **Equator**. Some parts of Antarctica are in the western hemisphere, while others are in the eastern hemisphere. The Pacific Ocean, the Indian Ocean, and the Atlantic Ocean surround Antarctica. Some people call the large body of water that circles the continent the Southern Ocean. The Weddell Sea and the Ross Sea can also help to describe Antarctica's relative location.

How can we best describe Antarctica's location?

STOP

The continent closest to Antarctica is South America. The Antarctic Peninsula stretches toward Cape Horn at the southern tip of South America. This peninsula is long and thin, and often surrounded by ice. The island of Tierra del Fuego is only about 600 miles away from Antarctica.



Antarctica - Location

1. Fill in each blank with a word from the list.

Antarctica Southern Ocean latitude longitude
 Ross Sea Tierra del Fuego relative location peninsula

Geographers use _____ and _____ to describe a place's absolute location. The _____ of a place is described by using the features around that place. _____ is a frosty continent surrounded by what some geographers call the _____. The Antarctic _____ stretches into this body of water, and is only about 600 miles away from South America and the island of _____. Ross Island is found beside the Ross Ice Shelf, in the _____.

2. Put a check mark (✓) next to the answer that is most correct.

a) The continent closest to Antarctica is _____.

- A North America
- B Europe
- C South America
- D Asia

b) The oceans surrounding Antarctica are _____.

- A Pacific Ocean
- B Indian Ocean
- C Atlantic Ocean
- D all of the above

c) Absolute location describes exactly where a place is by using _____.

- A physical features
- B the places around it
- C relative location
- D latitude and longitude



Antarctica - Location

Answer the questions in complete sentences.

3. Using latitude, describe Antarctica's location.

4. Why is it difficult to know the exact shape of Antarctica?

Research

5. The **South Pole** is located near the center of Antarctica. Many explorers tried to be the first to reach it. Who did reach the South Pole first? What other explorers have journeyed to Antarctica? Research these explorers, and complete the chart using the information you have found.

Explorer's Name	Country	Reached the South Pole?	Year	Other Facts

6. Antarctica is an important place for scientists to study and complete their research. Some study the atmosphere over Antarctica, some study the frozen continent's rocks, and some even look for rocks from space that have fallen there! **Where are the research stations of these scientists located?** Using an atlas or the Internet (with appropriate permission!), find the location of these research stations, and **draw them on a map of Antarctica**. Choose an appropriate **symbol** to represent them on your map.



Crossword Puzzle!

- WORD LIST**
 penguins
 longitude
 difficult
 climate
 desert
 snowmobiles
 scientists
 South America
 icebergs
 South Pole
 movement
 ozone
 icebreaker
 global warming
 equator
 uninhabited
 southern
 continent

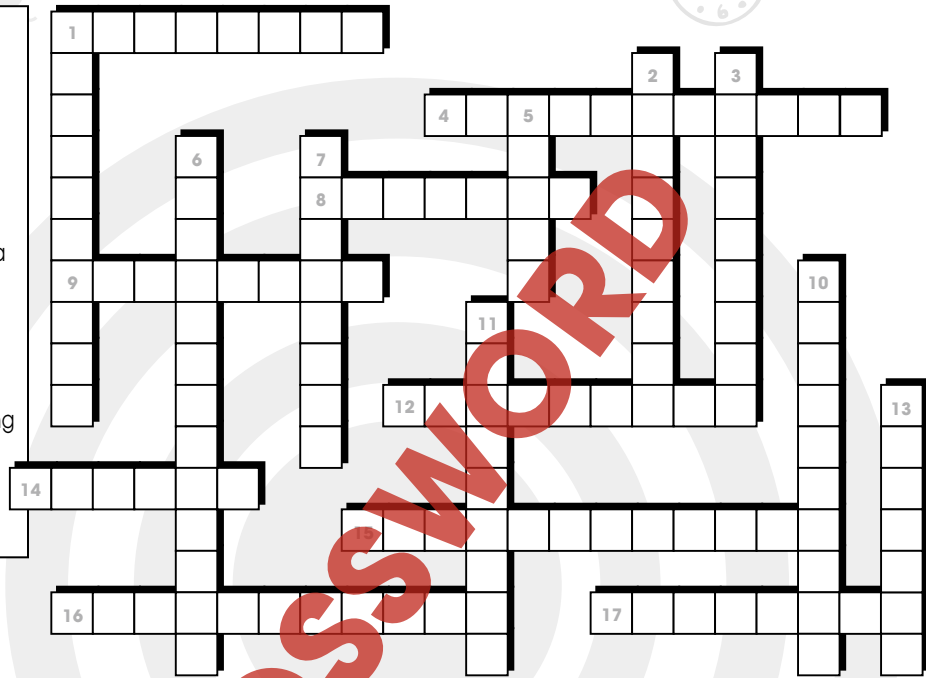

- Across**
- Antarctica is in the _____ hemisphere
 - Used to travel short distances in Antarctica
 - Imaginary line running around the middle of the Earth
 - _____ are one of Antarctica's unique physical characteristics
 - There are seven of these large land masses on Earth
 - Antarctica is a cold, frozen _____
 - The continent closest to Antarctica is _____
 - Much of Antarctica is _____ because few people live there
 - A word that describes how people, ideas and products move from place to place

- Down**
- The few people who visit Antarctica are _____
 - To find Antarctica on a map, look for the _____
 - It is very _____ to move from place to place in Antarctica
 - Pollution is harming the _____ layer in the atmosphere above Antarctica
 - Much of the pack ice is melting because of _____
 - A kind of wildlife that lives along the shores of the sea in Antarctica
 - A ship that breaks a path in the ice for other ships
 - Absolute location is the place where the lines of latitude and _____ cross
 - A word that describes the normal weather of a place



Word Search

Find all of the words in the Word Search. Words may be horizontal, vertical, or diagonal. A few may even be backwards! Look carefully!

- | | | | |
|-------------|----------------|-------------|-------------------|
| Antarctica | supplies | ozone layer | krill |
| peninsula | level | scientist | greenhouse effect |
| continent | lava | satellite | aerosol |
| wildlife | latitude | pack ice | uninhabited |
| species | place | longitude | ice shelf |
| environment | plankton | barren | active volcano |
| climate | global warming | lichen | shoreline |

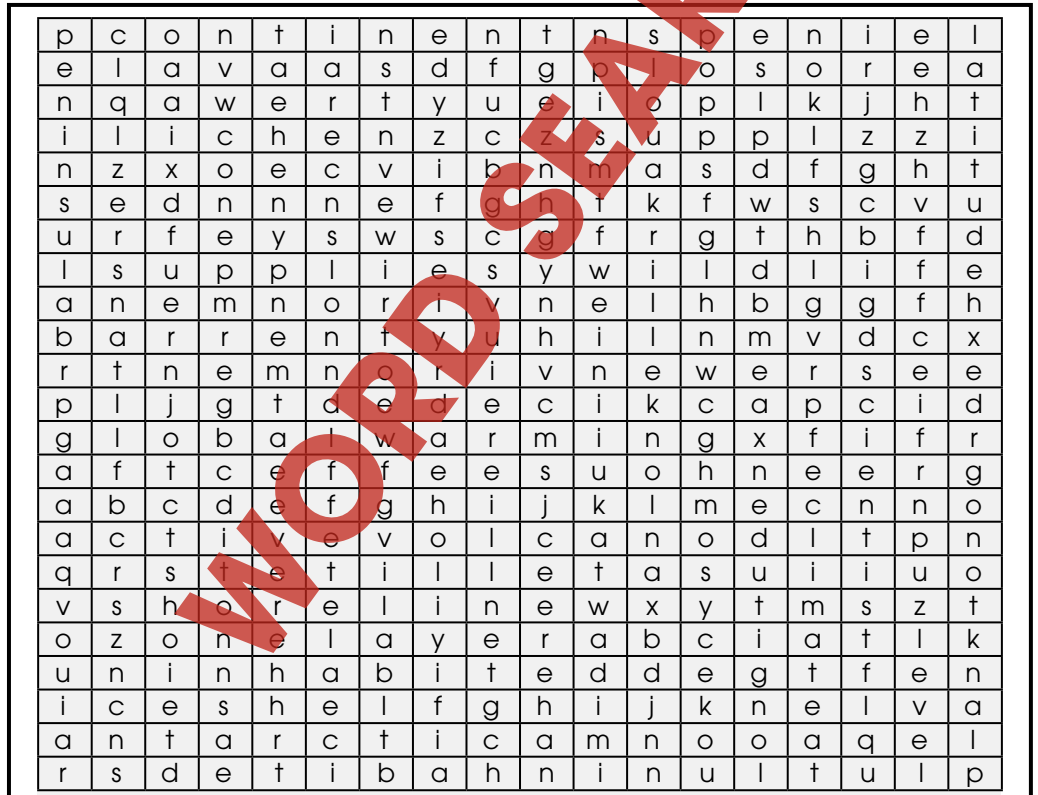

Comprehension Quiz

Part A

30

Circle the word TRUE if the statement is true. Circle the word FALSE if it's false.

- | | | |
|------|-------|---|
| TRUE | FALSE | a) Antarctica is in the northern hemisphere. |
| TRUE | FALSE | b) The South Pole is in Antarctica. |
| TRUE | FALSE | c) The Southern Ocean was once called the Antarctic Ocean. |
| TRUE | FALSE | d) North America is the continent closest to Antarctica. |
| TRUE | FALSE | e) There are no roads, railways, or large airports in Antarctica. |
| TRUE | FALSE | f) Mt. Erebus is an extinct volcano. |
| TRUE | FALSE | g) Tall trees grow in Antarctica. |
| TRUE | FALSE | h) More than one million people live in Antarctica. |

Part B

Label the map by doing the following:

- Show the following features on the map by writing the letter on the map in the correct location.

- South Pole
- 60°S latitude
- South America
- Atlantic Ocean
- Pacific Ocean



- Color the Prime Meridian red.

SUBTOTAL: /14

Antarctica World Location Map

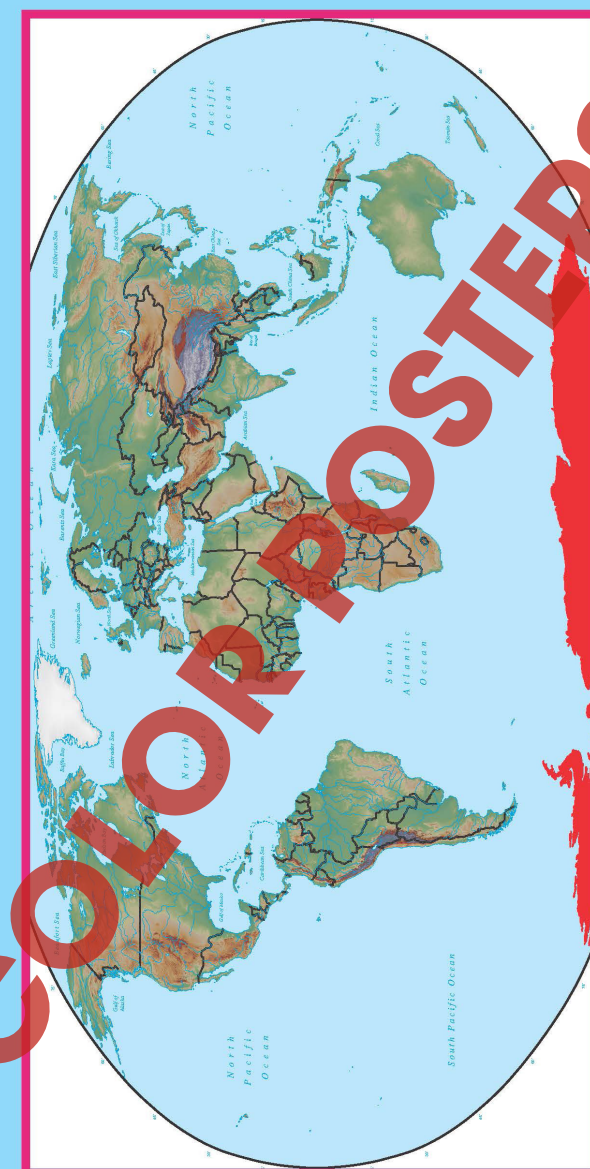



Antarctica - Location

Answer the questions in complete sentences.

3. Using latitude, describe Antarctica's location.

4. Why is it difficult to know the exact shape of Antarctica?

Research

5. The **South Pole** is located near the center of Antarctica. Many explorers tried to be the first to reach it. Who did reach the South Pole first? What other explorers have journeyed to Antarctica? Research these explorers, and complete the chart using the information you have found.

Explorer's Name	Country	Reached the South Pole?	Year	Other Facts

6. Antarctica is an important place for scientists to study and complete their research. Some study the atmosphere over Antarctica, some study the frozen continent's rocks, and some even look for rocks from space that have fallen there! **Where are the research stations of these scientists located?** Using an atlas or the Internet (with appropriate permission!), find the location of these research stations, and **draw them on a map of Antarctica**. Choose an appropriate **symbol** to represent them on your map.

3.
Entirely south of 60°S latitude

4.
The pack ice and the shelf ice around it often hide its true shape

5.
Possible answers:
Ernest Shackleton / England / NO / --- / reached Mt. Erebus, while exploring;
Roald Amundsen / Norway / YES / 1911 / also explored the North Pole; etc.

6.
Answers will vary depending on resource used

Across:

- 1. southern
- 4. snowmobiles
- 8. Equator
- 9. icebergs
- 12. continent
- 14. desert
- 15. South America
- 16. uninhabited
- 17. movement

Down:

- 1. scientists
- 2. South Pole
- 3. difficult
- 5. ozone
- 6. global warming
- 7. penguins
- 10. icebreaker
- 11. longitude
- 13. climate



EASY MARKING ANSWER KEY