

	<b>TEACHER GUIDE</b>	
•	Assessment Rubric .....	4
•	How Is Our Resource Organized? .....	5
•	Bloom's Taxonomy for Reading Comprehension .....	6
•	Vocabulary .....	6
	<b>STUDENT HANDOUTS</b>	
•	Reading Comprehension – Five Themes of Geography	
	1. Location .....	
	2. Place .....	7
	3. Human and Environmental Interactions .....	
	4. Movement .....	
	5. Regions .....	
•	Crossword .....	11
•	Word Search .....	12
•	Comprehension Quiz .....	13
	<b>EASY MARKING™ ANSWER KEY</b> .....	15
	<b>STUDENT BLACKLINE MAPS &amp; IMAGES</b> .....	17
	<b>MINI POSTERS</b> .....	29

**FREE!**

✓ **6 BONUS Activity Pages!** Additional worksheets for your students

- Go to our website: [www.classroomcompletepress.com/bonus](http://www.classroomcompletepress.com/bonus)
- Enter item CC5756
- Enter pass code CC5756D



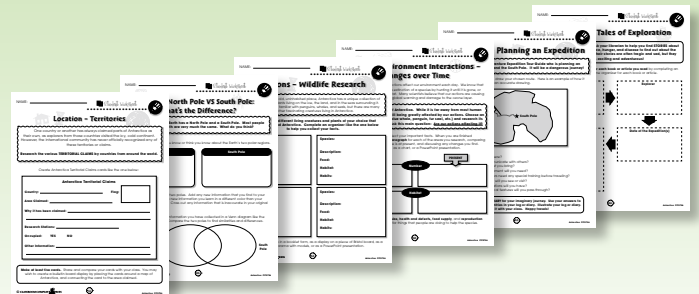

## Antarctica - Place

1. Antarctica is a continent unlike any of the others. Think about what you know, or what you think you know, about the continent at the southern part of the world. Use the boxes to organize your ideas. Use point form notes to record your ideas. Share your ideas with the class.

**Climate** (The normal weather of a place)

**Location** (Where a place is found)

**Population** (The people who live in a place)

**Wildlife** (The animals that live in a place)

**Other Ideas I Have**

2. **Thinking As You Learn: Returning to the sheet later in the unit.**

As you learn more about Antarctica, look back at this list. Confirm your accurate ideas with a **check mark** or **cross out** ideas that are inaccurate. You may also add to your notes any new ideas that you have learned. Use a colored pencil, crayon or a pen to show the new things you have learned.

**Think and write:** Which ideas of mine were confirmed?

**Think and write:** Which ideas needed to be crossed out and discarded?

**Think and write:** Which new ideas have I learned?



## Antarctica - Place

**A**ntarctica is a harsh continent with features that make it **unique** from all the other continents. What are these unique features? Its **physical characteristics** make it unique. There are mountains, ice shelves, and icebergs. The unusual wildlife of Antarctica also makes it unique. The fact that no people come from Antarctica also makes it unlike any other continent. Did you know that Antarctica has six months of darkness followed by six months of light? Each of these features helps us better understand Antarctica and describe it as a place.



Antarctica is a continent with few contrasts. While there are long mountain ranges that are easily seen, most areas of the continent are covered in a thick sheet of ice. In some places, this ice is more than two miles thick! Everywhere you look, you see ice, snow, or cold, **barren** rock. Even the waters surrounding Antarctica are frozen for much of the year. Tall, frosty **icebergs** can be seen floating in the icy waters. Large ice shelves and, in summer, a few small, rocky beaches are the home to penguins and seals. Whales swim in the icy coastal waters.

**STOP** What are some of Antarctica's physical characteristics?

The wildlife of Antarctica can be found along the shores of the sea. Many kinds of **penguins** live here, along with seals and whales at sea. Their food is found in the water, because few plants grow here except for **lichen**. Penguins and seals eat fish, while the whales eat **plankton** or **krill**. Most countries recognize the importance of preserving these **species**.

The few people who visit Antarctica are usually scientists who study this frozen land or the **atmosphere** above it. These researchers live in small research stations that have been designed to protect them from the cold, harsh weather. If these scientists were not there, there would be no people in Antarctica.



## Antarctica - Place

1. a) **Circle** those things that geographers use to describe **place**.

automobiles	wildlife	languages spoken	ships
where people live	mountains	physical characteristics	ice shelf

- b) Using the words that you have circled, write a short paragraph describing what is meant by the word **place**. You may look back at the reading for ideas as well.

\_\_\_\_\_

\_\_\_\_\_

\_\_\_\_\_

2. **Circle** the word **TRUE** if the statement is true. **Circle** the word **FALSE** if it's false.

- TRUE FALSE** a) Antarctica is covered with ice, snow, and barren rock.
- TRUE FALSE** b) The wildlife of Antarctica can be found along the shores of the sea.
- TRUE FALSE** c) Penguins and seals live on Antarctica's mountains.
- TRUE FALSE** d) Whales eat plankton and krill.
- TRUE FALSE** e) Antarctica has many unique peoples.
- TRUE FALSE** f) Most areas of Antarctica are covered in a thick sheet of ice!
- TRUE FALSE** g) Penguins and seals eat whales for food.
- TRUE FALSE** h) The waters around Antarctica never freeze.
- TRUE FALSE** i) Antarctica's cold conditions make it unique from all other continents.



## Antarctica - Place

**Answer each question with a complete sentence.**

3. What kinds of things do scientists study in Antarctica?
- \_\_\_\_\_
4. Describe the landscape of Antarctica.
- \_\_\_\_\_

### Research

5. Everyone knows that the South Pole is found in Antarctica. But have you ever wondered where the **South Magnetic Pole** is? Is it in Antarctica? Is it somewhere else? Using an atlas, find the South Magnetic Pole. Show the South Magnetic Pole on a map of Antarctica. Then research the South Magnetic Pole and find out how it affects **compasses** around the world.
6. The ice covering Antarctica is often more than two miles thick. That is more than 10 500 feet thick! That is equal to at least seven Empire State Buildings tall! For all of that ice to remain, Antarctica has a very cold climate. But just how cold is it?

**Research Antarctica's temperatures**, and complete the following boxes to share the information you have discovered.

Antarctica's Lowest Recorded Temperature:

Antarctica's "Warmest" Recorded Temperature:

Antarctica's Coldest Month of the Year:  
Average Temperature:

Antarctica's "Warmest" Month of the Year:  
Average Temperature:

Antarctica's Average Yearly Temperature:

Antarctica's Average Yearly Temperature is...  
**falling rising**





# Crossword Puzzle!

**WORD LIST**

- penguins
- longitude
- difficult
- climate
- desert
- snowmobiles
- scientists
- South America
- icebergs
- South Pole
- movement
- ozone
- icebreaker
- global warming
- equator
- uninhabited
- southern
- continent

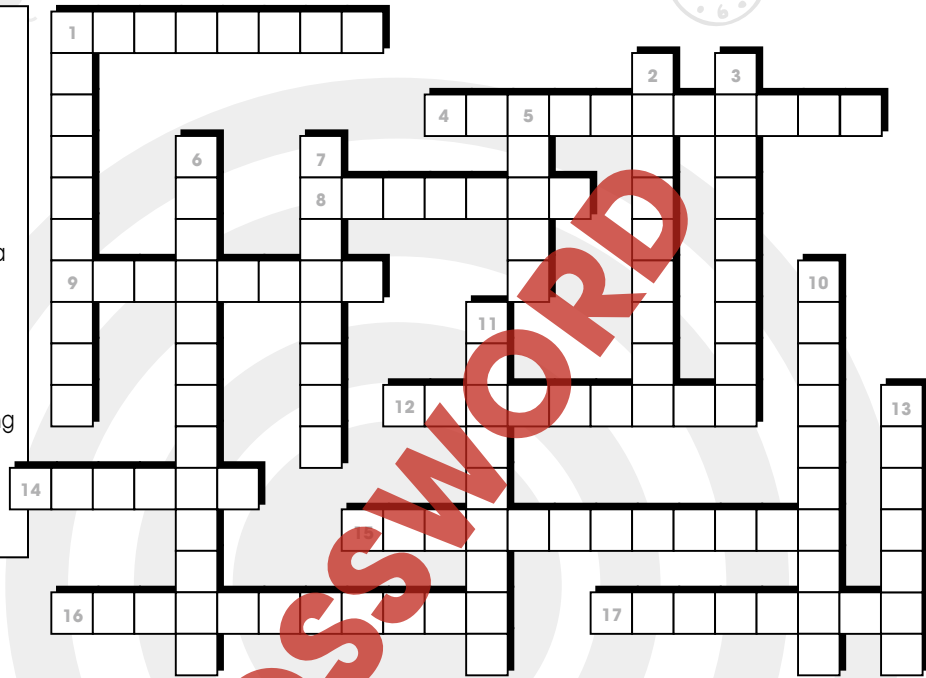

**Across**

- 1 Antarctica is in the \_\_\_\_\_ hemisphere
- 4 Used to travel short distances in Antarctica
- 8 Imaginary line running around the middle of the Earth
- 9 \_\_\_\_\_ are one of Antarctica's unique physical characteristics
- 12 There are seven of these large land masses on Earth
- 14 Antarctica is a cold, frozen \_\_\_\_\_
- 15 The continent closest to Antarctica is \_\_\_\_\_
- 16 Much of Antarctica is \_\_\_\_\_ because few people live there
- 17 A word that describes how people, ideas and products move from place to place

**Down**

- 1 The few people who visit Antarctica are \_\_\_\_\_
- 2 To find Antarctica on a map, look for the \_\_\_\_\_
- 3 It is very \_\_\_\_\_ to move from place to place in Antarctica
- 5 Pollution is harming the \_\_\_\_\_ layer in the atmosphere above Antarctica
- 6 Much of the pack ice is melting because of \_\_\_\_\_
- 7 A kind of wildlife that lives along the shores of the sea in Antarctica
- 10 A ship that breaks a path in the ice for other ships
- 11 Absolute location is the place where the lines of latitude and \_\_\_\_\_ cross
- 13 A word that describes the normal weather of a place



# Word Search

Find all of the words in the Word Search. Words may be horizontal, vertical, or diagonal. A few may even be backwards! Look carefully!

- |             |                |             |                   |
|-------------|----------------|-------------|-------------------|
| Antarctica  | supplies       | ozone layer | krill             |
| peninsula   | level          | scientist   | greenhouse effect |
| continent   | lava           | satellite   | aerosol           |
| wildlife    | latitude       | pack ice    | uninhabited       |
| species     | place          | longitude   | ice shelf         |
| environment | plankton       | barren      | active volcano    |
| climate     | global warming | lichen      | shoreline         |

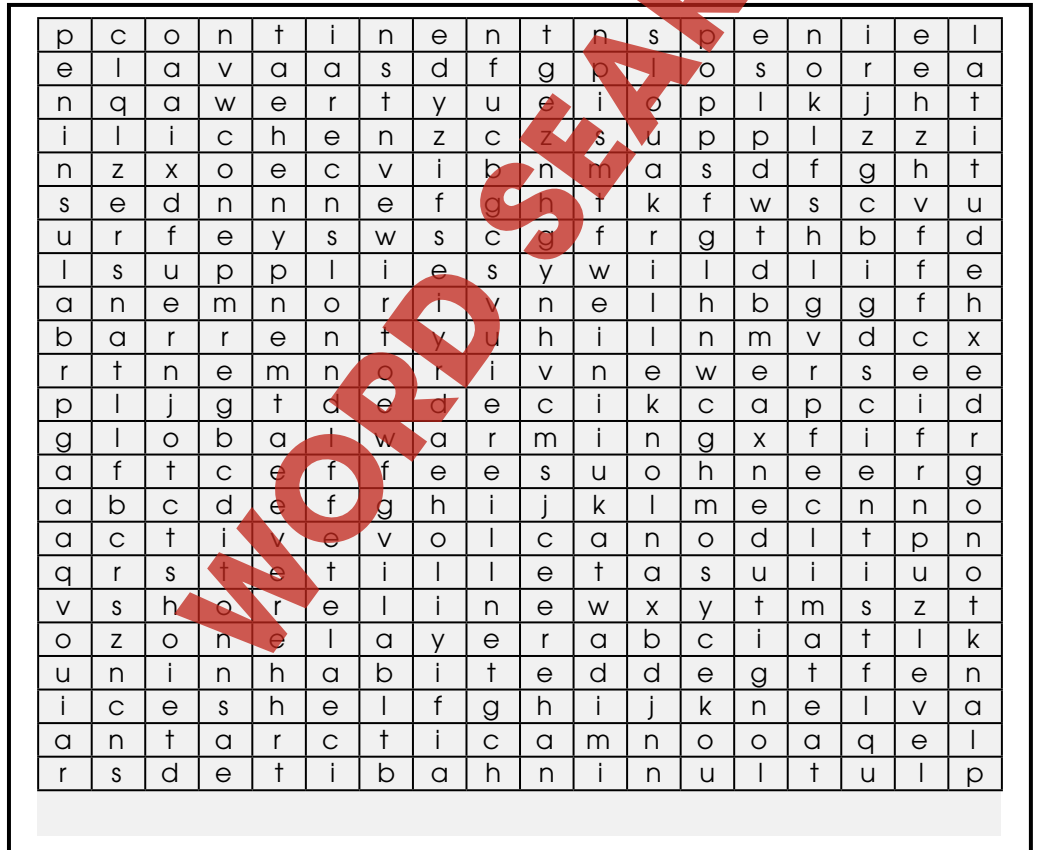

# Comprehension Quiz

**Part C**

Answer the questions in complete sentences.

1. What is the difference between **absolute** location and **relative** location? As an example, describe Antarctica's relative location. 3  
 \_\_\_\_\_  
 \_\_\_\_\_  
 \_\_\_\_\_
2. How do we describe **place**? Describe Antarctica as a place. 3  
 \_\_\_\_\_  
 \_\_\_\_\_  
 \_\_\_\_\_
3. Describe what is meant by **human and environmental interactions**. Explain how global warming is affecting Antarctica's ice shelves and pack ice. 3  
 \_\_\_\_\_  
 \_\_\_\_\_  
 \_\_\_\_\_
4. What do we mean by **movement** in geography? Why is movement difficult in Antarctica? Give at least two reasons. 3  
 \_\_\_\_\_  
 \_\_\_\_\_  
 \_\_\_\_\_
5. What is a **region**? Describe Antarctica as a region. 4  
 \_\_\_\_\_  
 \_\_\_\_\_  
 \_\_\_\_\_

**SUBTOTAL: /16**

# Antarctica Outline Map

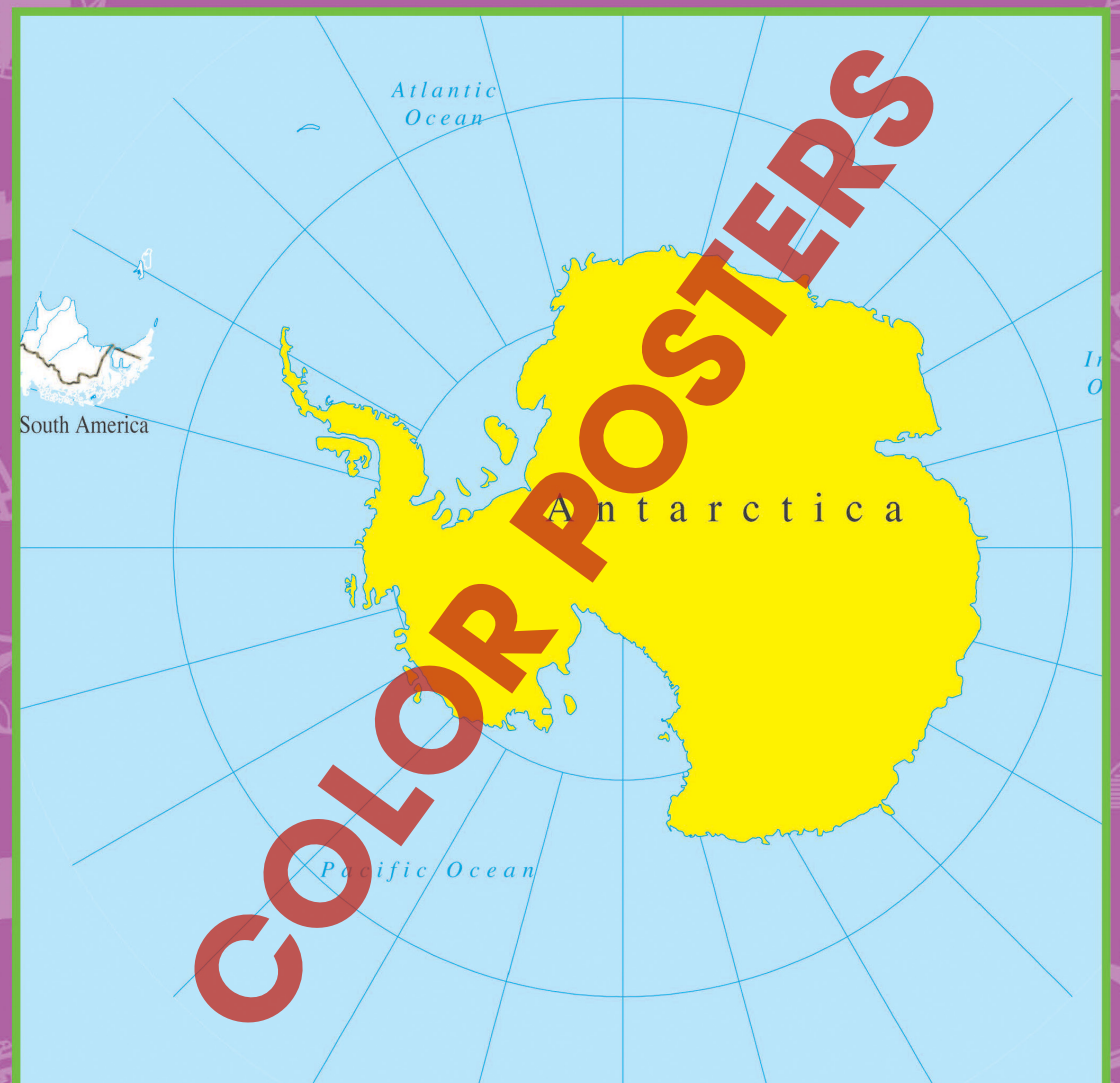



# Antarctica - Place



Answer each question with a complete sentence.

3. What kinds of things do scientists study in Antarctica?

\_\_\_\_\_

4. Describe the landscape of Antarctica.

\_\_\_\_\_

## Research

5. Everyone knows that the South Pole is found in Antarctica. But have you ever wondered where the **South Magnetic Pole** is? Is it in Antarctica? Is it somewhere else? Using an atlas, find the South Magnetic Pole. Show the South Magnetic Pole on a map of Antarctica. Then research the South Magnetic Pole and find out how it affects **compasses** around the world.

6. The ice covering Antarctica is often more than two miles thick. That is more than 10 500 feet thick! That is equal to at least seven Empire State Buildings tall! For all of that ice to remain, Antarctica has a very cold climate. But just how cold is it?

Research Antarctica's temperatures, and complete the following boxes to share the information you have discovered.

Antarctica's Lowest Recorded Temperature:

Antarctica's "Warmest" Recorded Temperature:

Antarctica's Coldest Month of the Year:  
Average Temperature:

Antarctica's "Warmest" Month of the Year:  
Average Temperature:

Antarctica's Average Yearly Temperature:

Antarctica's Average Yearly Temperature is...  
**falling**      **rising**

3. The atmosphere, the frozen landscape, etc.

4. Ice sheet, mountains, cold, barren rock, some rocky beaches, etc.

5. Answers will vary in accuracy depending upon resource used and mapping skills

6. Answers will definitely vary depending on the resource used.  
Possible answers:  
Average coldest temperature is -125°F (winter, July/Aug.)  
average "warmest" temperature is approx. -95°F (summer, Jan./Feb.); etc.

### Across:

- 1. southern
- 4. snowmobiles
- 8. Equator
- 9. icebergs
- 12. continent
- 14. desert
- 15. South America
- 16. uninhabited
- 17. movement

### Down:

- 1. scientists
- 2. South Pole
- 3. difficult
- 5. ozone
- 6. global warming
- 7. penguins
- 10. icebreaker
- 11. longitude
- 13. climate

10

11



# EASY MARKING ANSWER KEY