

	<b>TEACHER GUIDE</b>	
	• Assessment Rubric .....	4
	• How Is Our Resource Organized? .....	5
	• Bloom's Taxonomy for Reading Comprehension .....	6
	• Vocabulary .....	6
	<b>STUDENT HANDOUTS</b>	
	• Reading Comprehension – Five Themes of Geography	
	1. Location .....	
	2. Place .....	
	3. Human and Environmental Interactions .....	
	4. Movement.....	7
	5. Regions .....	
	• Crossword .....	12
	• Word Search .....	13
	• Comprehension Quiz .....	14
	<b>EASY MARKING™ ANSWER KEY</b> .....	16
	<b>STUDENT BLACKLINE MAPS &amp; IMAGES</b> .....	18
	<b>MINI POSTERS</b> .....	30

**FREE!**

✓ **6 BONUS Activity Pages!** Additional worksheets for your students

- Go to our website: [www.classroomcompletepress.com/bonus](http://www.classroomcompletepress.com/bonus)
- Enter item CC5756
- Enter pass code CC5756D



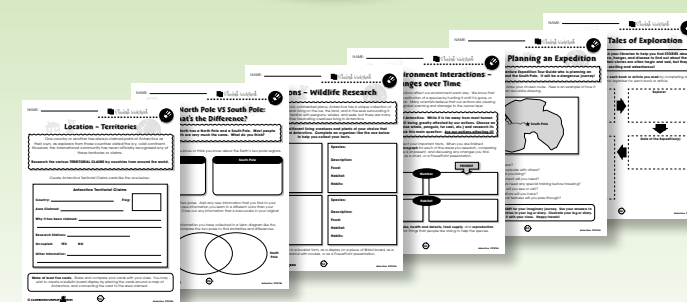

## Antarctica - Movement

1. Match the word to its definition and then to the correct illustration. You may use an atlas or a dictionary to help.

**communication**

An area outside a city. The country is an example. There are fewer people and services than in a city, and they are spread out across wide areas of land.

**rural**

The sharing of ideas through many different ways, such as through speech, printed words, signals, sign language, and images.

**transportation**

The word used to describe how humans move themselves and other items from place to place. It includes the vehicles we use and the things they travel on (air, water, roads, etc.).

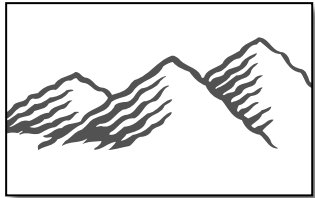

A



B

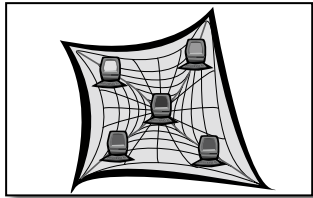

C

2. Different seasons, in different places, can affect the way in which people travel to work, to school, or to recreational activities. In each of the boxes below, list all of the different and unique ways in which **people can travel in a particular season**. For this work, think about places like Chicago, Illinois, or Albany, New York, that have four distinct, and very different seasons. Think about urban and rural areas too.

**Winter**

**Spring**

**Summer**

**Autumn**



## Antarctica - Movement

**M**ovement is a word that describes how people, ideas, and products move from place to place. Antarctica's cold climate affects movement every day. Many scientists visit Antarctica each year. They often find themselves in dangerous weather conditions, and cannot travel very far. The cold and ice can affect their vehicles. Delivering important products and supplies can be very difficult.



Antarctica is very different from other continents. Antarctica is **uninhabited**. That means no people live there. It is also too cold and has too many windy storms. There are no roads, railways, or large airports to help people move from place to place. Many scientists work in Antarctica, but most leave before bad, winter weather arrives. When the weather gets bad, nobody goes anywhere. Getting around in Antarctica is extremely difficult!

**STOP** Why is travel difficult in Antarctica?

\_\_\_\_\_

\_\_\_\_\_

\_\_\_\_\_

Special ships bring scientists to Antarctica, and special planes deliver their **supplies**. Icebreaker ships break a path in the pack ice so other ships can travel safely. **Snowmobiles** and other special vehicles help the scientists travel short distances. These vehicles move on rubber tracks instead of wheels. The tracks provide good grip on the ice and snow.

Even though the scientists are **isolated** by hundreds of miles of ice and snow, they still share their ideas in many different ways. Radios are very important for sharing ideas. A radio provides a link to other scientists throughout the world. Ideas are also spread by television or by satellite dish. Telephone calls, letters, and the Internet are also used. These allow the scientists to keep in touch with the rest of the world.



## Antarctica - Movement

1. **Circle** the word **TRUE** if the statement is true. **Circle** the word **FALSE** if it's false.

- TRUE FALSE** a) Snowmobiles are used to travel short distances in Antarctica.
- TRUE FALSE** b) Scientists in Antarctica share their ideas by using satellites, radios, and the Internet.
- TRUE FALSE** c) People travel on roads and railways in Antarctica.
- TRUE FALSE** d) Antarctica has a large population.
- TRUE FALSE** e) Antarctica has very mild winters.
- TRUE FALSE** f) Delivering products to Antarctica is very difficult.

2. Using the reading passage or a dictionary, find the definitions for each of the following words. Then use each word correctly in a sentence.

**satellite:** \_\_\_\_\_  
sentence: \_\_\_\_\_

**product:** \_\_\_\_\_  
sentence: \_\_\_\_\_

**uninhabited:** \_\_\_\_\_  
sentence: \_\_\_\_\_

**climate:** \_\_\_\_\_  
sentence: \_\_\_\_\_

**Internet:** \_\_\_\_\_  
sentence: \_\_\_\_\_



## Antarctica - Movement

**Answer each question with a complete sentence.**

3. Why is Antarctica uninhabited?  
\_\_\_\_\_

4. List some of the ways that scientists in Antarctica communicate with other parts of the world.  
\_\_\_\_\_

- Research and Applications**
5. Using the graphic organizer on the next page, **Snow and Ice Transportation**, research some of the ways in which people in Antarctica move around in their harsh climate. Share your findings with a partner.
6. Think about how an orange gets from its tree to your home. Read the flow chart to understand the things that might happen:



Think about how **food and other supplies** get to the people researching in Antarctica. Then conduct some research into movement in Antarctica. **Show the steps** on a flow chart.

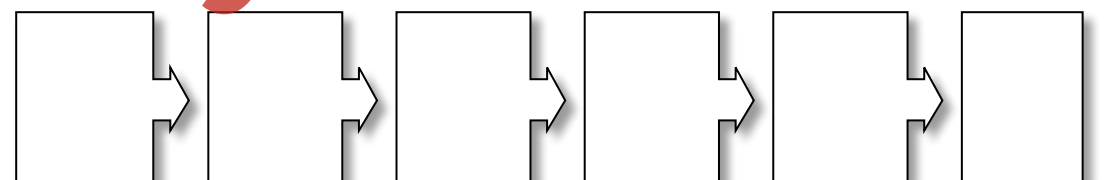

Share what you have learned with your class.



# Crossword Puzzle!

### WORD LIST

- penguins
- longitude
- difficult
- climate
- desert
- snowmobiles
- scientists
- South America
- icebergs
- South Pole
- movement
- ozone
- icebreaker
- global warming
- equator
- uninhabited
- southern
- continent

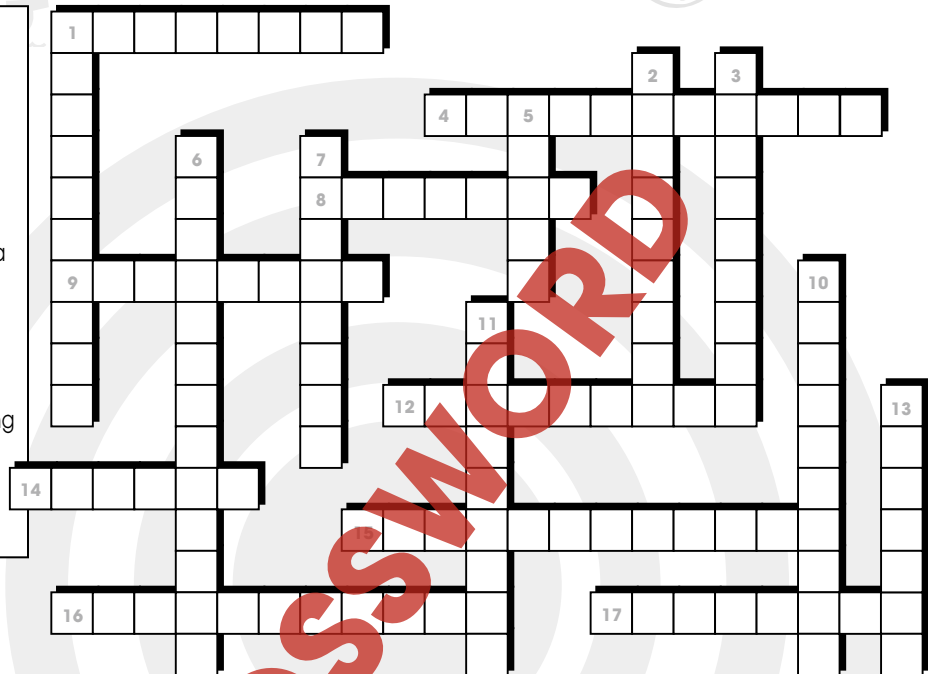

### Across

- Antarctica is in the \_\_\_\_\_ hemisphere
- Used to travel short distances in Antarctica
- Imaginary line running around the middle of the Earth
- \_\_\_\_\_ are one of Antarctica's unique physical characteristics
- There are seven of these large land masses on Earth
- Antarctica is a cold, frozen \_\_\_\_\_
- The continent closest to Antarctica is \_\_\_\_\_
- Much of Antarctica is \_\_\_\_\_ because few people live there
- A word that describes how people, ideas and products move from place to place

### Down

- The few people who visit Antarctica are \_\_\_\_\_
- To find Antarctica on a map, look for the \_\_\_\_\_
- It is very \_\_\_\_\_ to move from place to place in Antarctica
- Pollution is harming the \_\_\_\_\_ layer in the atmosphere above Antarctica
- Much of the pack ice is melting because of \_\_\_\_\_
- A kind of wildlife that lives along the shores of the sea in Antarctica
- A ship that breaks a path in the ice for other ships
- Absolute location is the place where the lines of latitude and \_\_\_\_\_ cross
- A word that describes the normal weather of a place

# Word Search

Find all of the words in the Word Search. Words may be horizontal, vertical, or diagonal. A few may even be backwards! Look carefully!

- Antarctica
- peninsula
- continent
- wildlife
- species
- environment
- climate
- supplies
- level
- lava
- latitude
- place
- plankton
- global warming
- ozone layer
- scientist
- satellite
- pack ice
- longitude
- barren
- lichen
- krill
- greenhouse effect
- aerosol
- uninhabited
- ice shelf
- active volcano
- shoreline

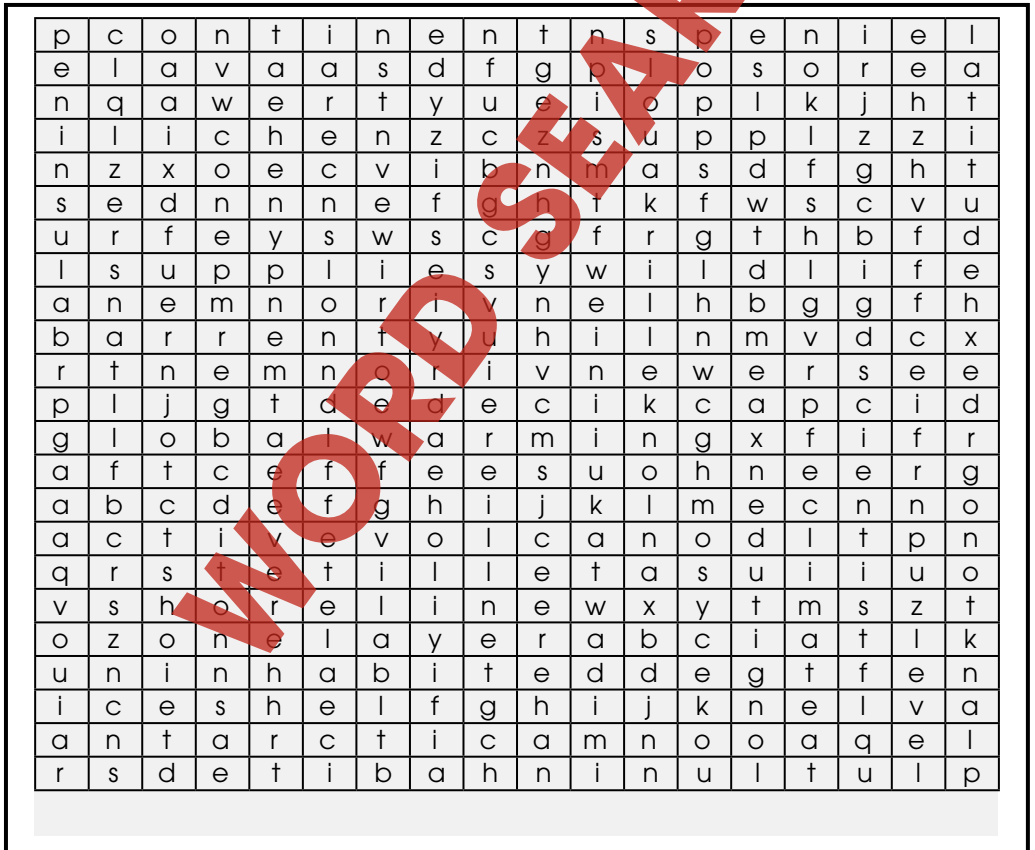

# Comprehension Quiz

### Part C

Answer the questions in complete sentences.

- What is the difference between **absolute** location and **relative** location? As an example, describe Antarctica's relative location. 3
- How do we describe **place**? Describe Antarctica as a place. 3
- Describe what is meant by **human and environmental interactions**. Explain how global warming is affecting Antarctica ice shelves and pack ice. 3
- What do we mean by **movement** in geography? Why is movement difficult in Antarctica? Give at least two reasons. 3
- What is a **region**? Describe Antarctica as a region. 4

SUBTOTAL: /16

# Antarctica Political Map

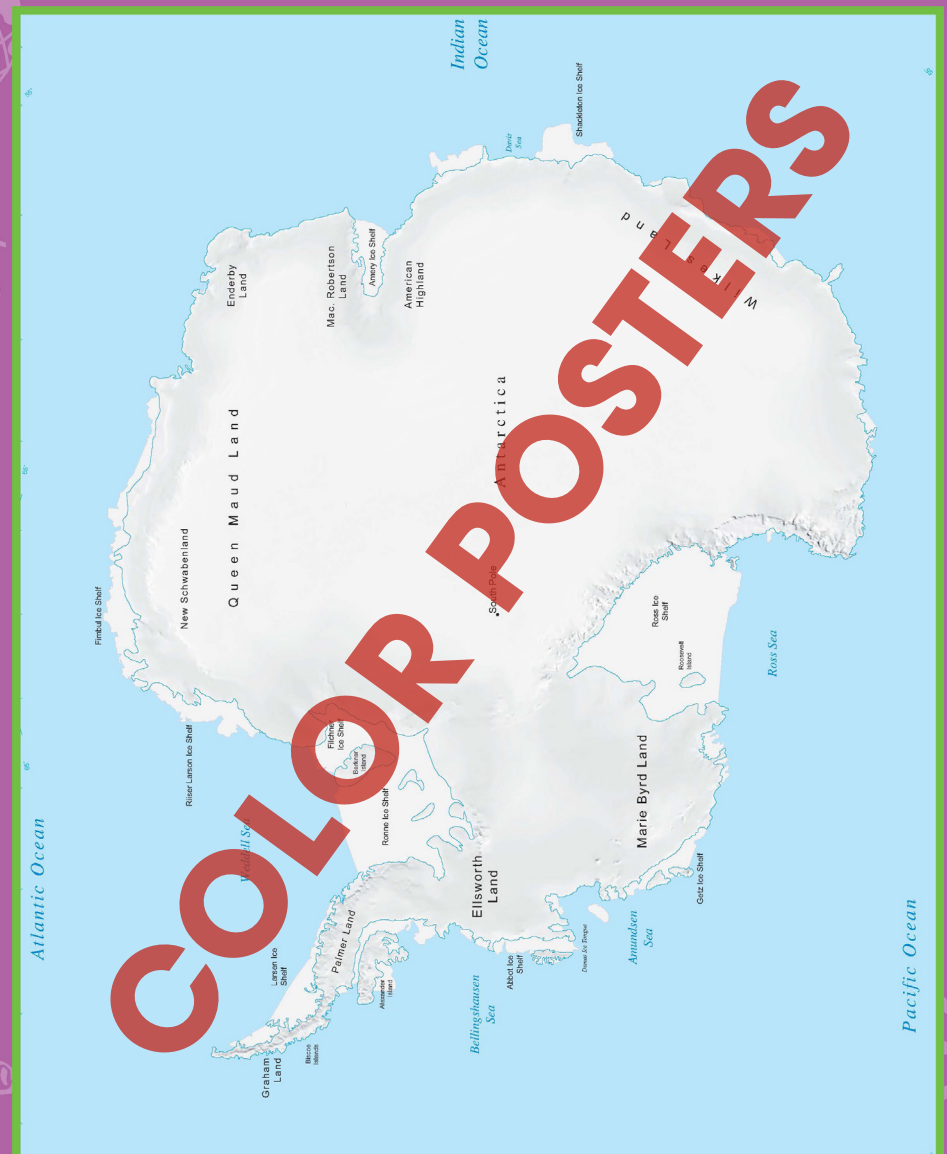

NAME: \_\_\_\_\_

After You Read 

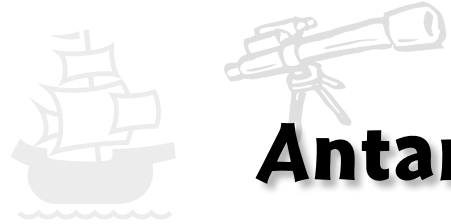

# Antarctica - Movement

1. **Circle** the word **TRUE** if the statement is true. **Circle** the word **FALSE** if it's false.

- TRUE**   **FALSE**   a) Snowmobiles are used to travel short distances in Antarctica.
- TRUE**   **FALSE**   b) Scientists in Antarctica share their ideas by using satellites, radios, and the Internet.
- TRUE**   **FALSE**   c) People travel on roads and railways in Antarctica.
- TRUE**   **FALSE**   d) Antarctica has a large population.
- TRUE**   **FALSE**   e) Antarctica has very mild winters.
- TRUE**   **FALSE**   f) Delivering products to Antarctica is very difficult.

2. Using the reading passage or a dictionary, find the definitions for each of the following words. Then use each word correctly in a sentence.

**satellite:** \_\_\_\_\_

sentence: \_\_\_\_\_

**product:** \_\_\_\_\_

sentence: \_\_\_\_\_

**uninhabited:** \_\_\_\_\_

sentence: \_\_\_\_\_

**climate:** \_\_\_\_\_

sentence: \_\_\_\_\_

**Internet:** \_\_\_\_\_

sentence: \_\_\_\_\_

# EASY MARKING ANSWER KEY

1.

- a) **T**
- b) **T**
- c) **F**
- d) **F**
- e) **F**
- f) **T**

2.

Possible answers:  
**satellite:** a device in orbit around the earth for communication purposes;  
**product:** something manufactured for our use;  
**uninhabited:** no population;  
**climate:** the usual weather conditions of an area;  
**Internet:** a network of computers and websites for sharing information, etc.  
 All sentences will

9

3.

Possible answers: too cold, harsh climate, etc.

4.

Possible answers: Internet, radio, letters, etc.

5.

Answers will vary in complexity and detail depending on the resources used

6.

Answers will vary in complexity and detail depending on the resources used

10

**Across:**

- 1. southern
- 4. snowmobiles
- 8. Equator
- 9. icebergs
- 12. continent
- 14. desert
- 15. South America
- 16. uninhabited
- 17. movement

**Down:**

- 1. scientists
- 2. South Pole
- 3. difficult
- 5. ozone
- 6. global warming
- 7. penguins
- 10. Icebreaker
- 11. longitude
- 13. climate

12

