

	TEACHER GUIDE	
•	Assessment Rubric	4
•	How Is Our Resource Organized?	5
•	Bloom's Taxonomy for Reading Comprehension	6
•	Vocabulary	6
	STUDENT HANDOUTS	
•	Reading Comprehension – Five Themes of Geography	
	1. Location	
	2. Place	
	3. Human and Environmental Interactions	
	4. Movement	
	5. Regions	7
•	Crossword	12
•	Word Search	13
•	Comprehension Quiz	14
	EASY MARKING™ ANSWER KEY	16
	STUDENT BLACKLINE MAPS & IMAGES	18
	MINI POSTERS	30

FREE!

✓ **6 BONUS Activity Pages!** Additional worksheets for your students

- Go to our website: www.classroomcompletepress.com/bonus
- Enter item CC5756
- Enter pass code CC5756D



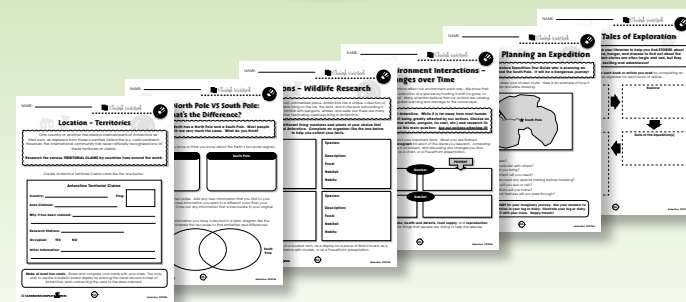

Antarctica - Regions

1. If you were planning to write a guide book about several rooms in your home, how would you describe each room?

Think about these things:

size characteristics how and why people use it

In the box beside each special room's name, give details about that room in your home. Share your **My Home's Three Special Rooms** work with a small group of friends.

a) My kitchen

b) My living room

c) _____
your choice

2. Use a dictionary to find the definitions of the following words.

- a) region _____
- b) ice shelf _____
- c) pack ice _____
- d) volcano _____
- e) lava _____



Antarctica - Regions



A region is an area of land that can be either large or small. A region is described by the **features** that make it unique.

Physical characteristics and the languages that people speak in a region help us to describe it. Antarctica is different. Nobody comes from Antarctica, so language cannot be used to describe it. **Geographers** can identify many physical features, such as mountains and **ice shelves**, but all of these are similar. They are all part of a cold, frozen desert. What interests geographers these days are the changes happening in Antarctica because of changes to the Earth's climate.



Antarctica is covered by a sheet of ice more than two miles thick! If all of the ice covering Antarctica were removed, the land would look very different. Mountains would appear taller. A cold landscape would be visible. Islands that are now covered by ice would appear. The shoreline would also look very different. Unfortunately, many scientists feel that some of this may already be happening because of **global warming**. They fear that the **pack ice** that surrounds Antarctica is disappearing. They notice that some of Antarctica's ice shelves are already melting very quickly. As the ice melts, this extra water may cause the level of the sea to rise!



How do geographers describe regions?

One of Antarctica's most unusual features is found on Ross Island, at the edge of the Ross Ice Shelf in the Ross Sea. Rising from the cold and the ice is an **active volcano** more than 12,000 feet tall! This volcano is called Mount Erebus, and it looks just like any other mountain covered in snow. What makes it different is the hot lava in its cone that can be seen from above. Steam from the cone rises into the cold air, letting scientists know that it is a very dangerous place to be!



Antarctica - Regions

1. Which features make Antarctica unique? Highlight or color the icebergs that correctly show a feature of Antarctica.

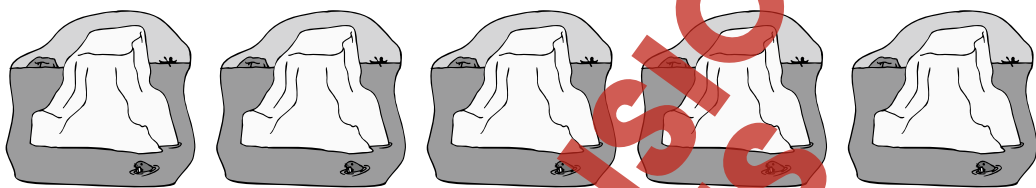

ice shelves forests people mountains volcano

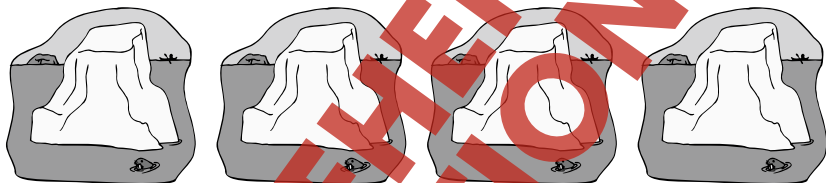

pack ice cities and towns Ross Sea climate change

1. Circle the word **TRUE** if the statement is true. Circle the word **FALSE** if it's false.

- TRUE** **FALSE** a) Mt. Erebus is an active volcano.
- TRUE** **FALSE** b) Changes in the earth's climate are affecting the pack ice around Antarctica.
- TRUE** **FALSE** c) As the ice melts, the level of the sea may fall.
- TRUE** **FALSE** d) Language can be used to describe regions in Antarctica.
- TRUE** **FALSE** e) Mt. Erebus is on the Ross Ice Shelf.
- TRUE** **FALSE** f) Geographers are very interested in the changes happening in Antarctica.
- TRUE** **FALSE** g) Mt. Erebus is 12,000 feet tall.
- TRUE** **FALSE** h) There is hot lava in Mt. Erebus' cone.



Antarctica - Regions



Answer each question with a complete sentence.

- 3. Be like a geographer! Describe Mt. Erebus.

- 4. How would Antarctica look differently if all of its ice sheet melted?

Research and Extensions

- 5. Using the Organizer on the following page **Mt. Erebus - Antarctica's Active Volcano**, research Mt. Erebus and several other volcanoes found in different parts of the world. Share your findings with a partner.
- 6. While most of Antarctica appears to be the same, all ice and snow, several parts of the continent have been given special names. Research and complete the chart to find out about each of the following areas, and why they were given their names.

Area Name	Named after...	Named by...	Year
a) Queen Maud Land			
b) Enderby Land			
c) Prince Charles Mountains			
d) Queen Mary Land			
e) Wilkes Land			
f) Victoria Land			
g) Ross Ice Shelf			
h) Beardmore Glacier			
i) Marie Byrd Land			
j) Coats Land			
k) Princess Martha Coast			



Crossword Puzzle!

- WORD LIST**
- penguins
 - longitude
 - difficult
 - climate
 - desert
 - snowmobiles
 - scientists
 - South America
 - icebergs
 - South Pole
 - movement
 - ozone
 - icebreaker
 - global warming
 - equator
 - uninhabited
 - southern
 - continent

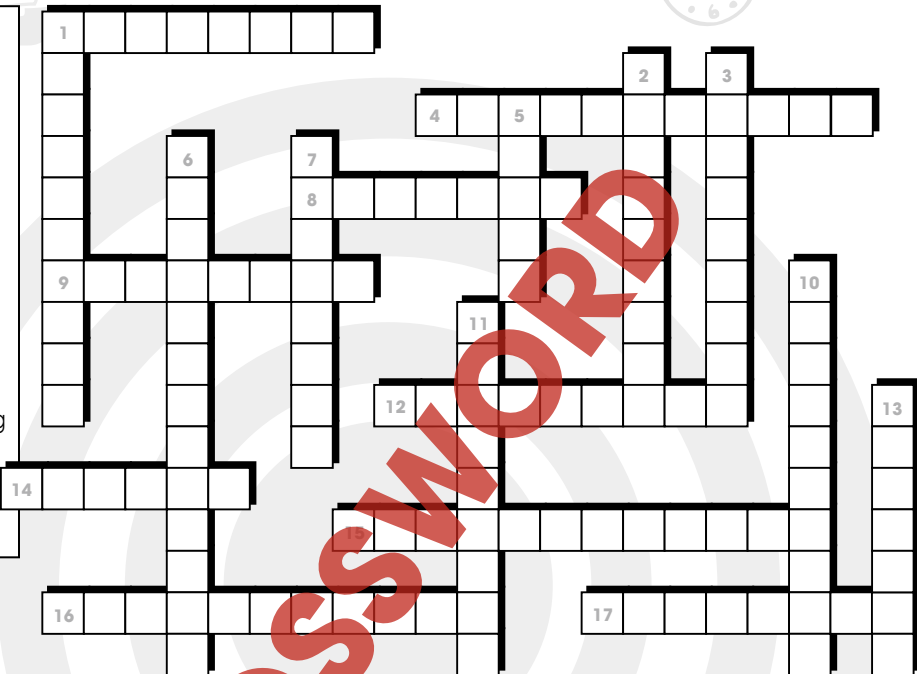

Across

- Antarctica is in the _____ hemisphere
- Used to travel short distances in Antarctica
- Imaginary line running around the middle of the Earth
- _____ are one of Antarctica's unique physical characteristics
- There are seven of these large land masses on Earth
- Antarctica is a cold, frozen _____
- The continent closest to Antarctica is _____
- Much of Antarctica is _____ because few people live there
- A word that describes how people, ideas and products move from place to place

Down

- The few people who visit Antarctica are _____
- To find Antarctica on a map, look for the _____
- It is very _____ to move from place to place in Antarctica
- Pollution is harming the _____ layer in the atmosphere above Antarctica
- Much of the pack ice is melting because of _____
- A kind of wildlife that lives along the shores of the sea in Antarctica
- A ship that breaks a path in the ice for other ships
- Absolute location is the place where the lines of latitude and _____ cross
- A word that describes the normal weather of a place

Word Search

Find all of the words in the Word Search. Words may be horizontal, vertical, or diagonal. A few may even be backwards! Look carefully!

- Antarctica
- peninsula
- continent
- wildlife
- species
- environment
- climate
- supplies
- level
- lava
- latitude
- place
- plankton
- global warming
- ozone layer
- scientist
- satellite
- pack ice
- longitude
- barren
- lichen
- krill
- greenhouse effect
- aerosol
- uninhabited
- ice shelf
- active volcano
- shoreline

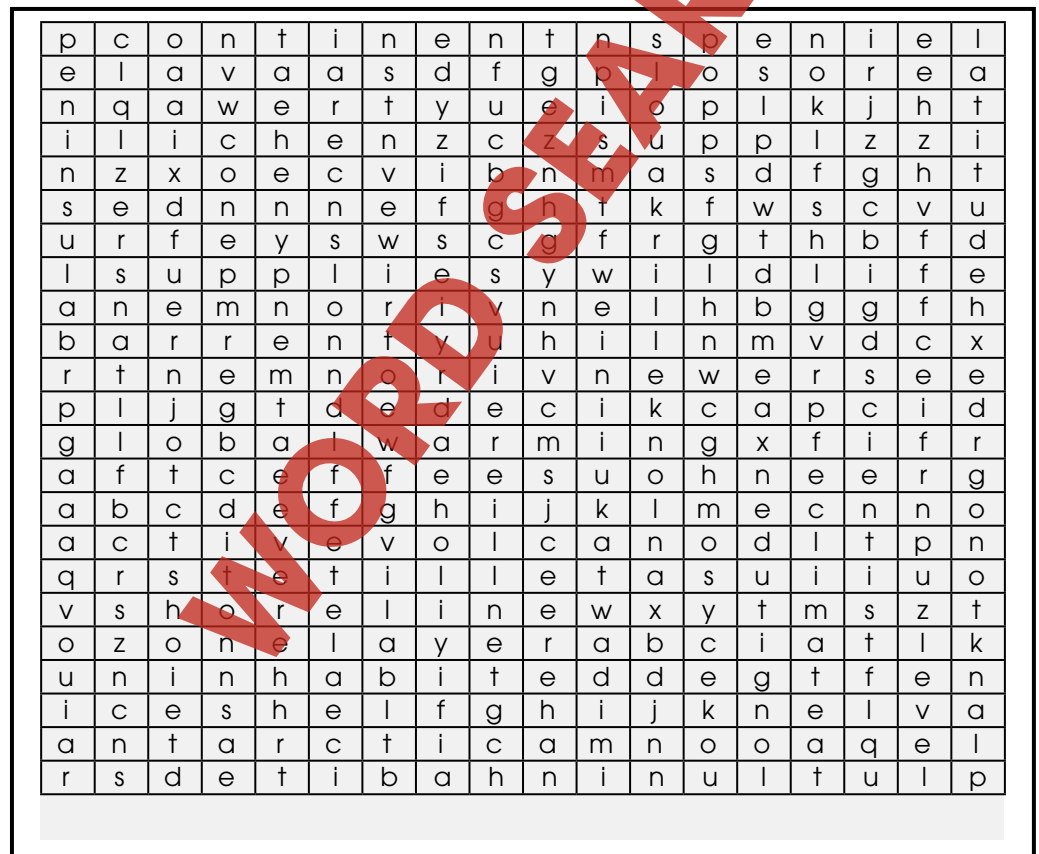

Comprehension Quiz

Part A

30

Circle the word TRUE if the statement is true. Circle the word FALSE if it's false.

- TRUE FALSE** a) Antarctica is in the northern hemisphere.
- TRUE FALSE** b) The South Pole is in Antarctica.
- TRUE FALSE** c) The Southern Ocean was once called the Antarctic Ocean.
- TRUE FALSE** d) North America is the continent closest to Antarctica.
- TRUE FALSE** e) There are no roads, railways, or large airports in Antarctica.
- TRUE FALSE** f) Mt. Erebus is an extinct volcano.
- TRUE FALSE** g) Tall trees grow in Antarctica.
- TRUE FALSE** h) More than one million people live in Antarctica.

Part B

Label the map by doing the following:

- Show the following features on the map by writing the letter on the map in the correct location.

- a) South Pole
- b) 60°S latitude
- c) South America
- d) Atlantic Ocean
- e) Pacific Ocean



6

- Color the Prime Meridian red.

SUBTOTAL: /14

Antarctica Flag



NAME: _____

After You Read 



Antarctica - Regions

1. Which features make Antarctica unique? Highlight or color the icebergs that correctly show a feature of Antarctica.

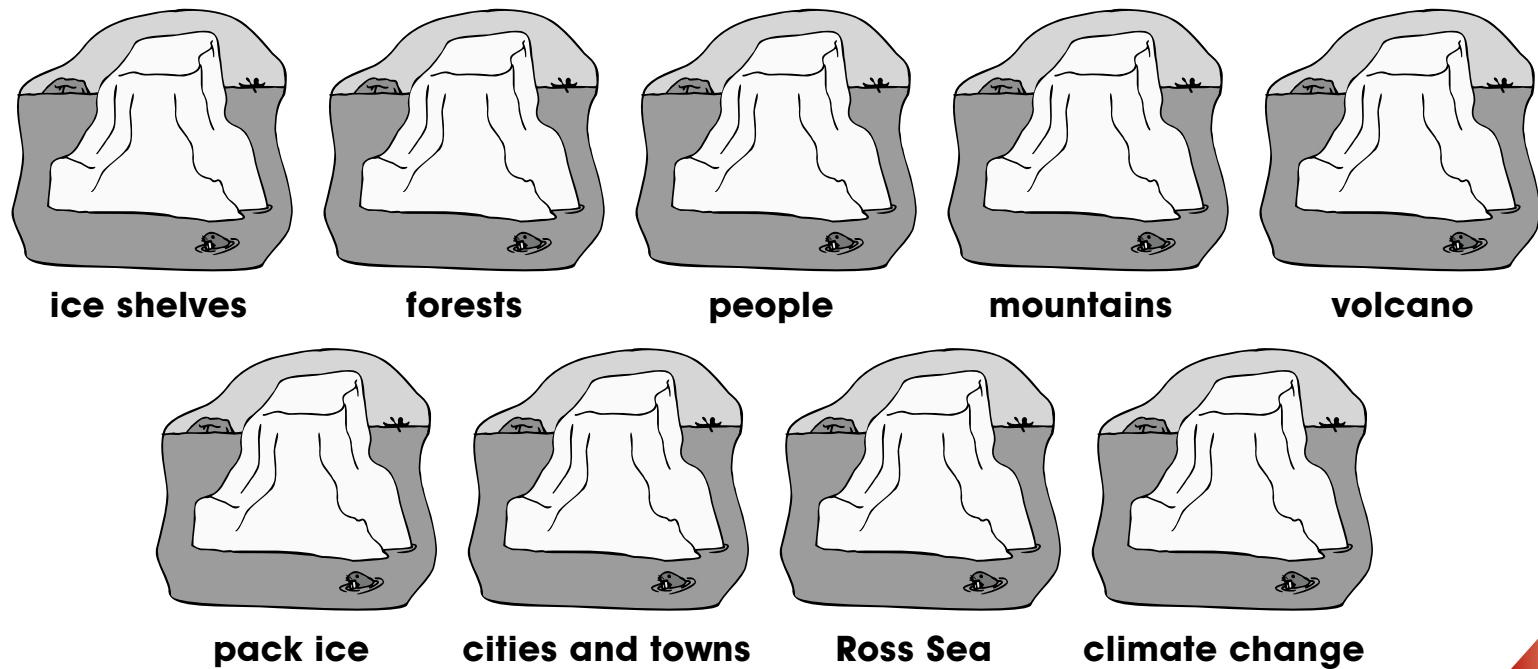

1. Circle the word TRUE if the statement is true. Circle the word FALSE if it's false.

- | | | |
|------|-------|---|
| TRUE | FALSE | a) Mt. Erebus is an active volcano. |
| TRUE | FALSE | b) Changes in the earth's climate are affecting the pack ice around Antarctica. |
| TRUE | FALSE | c) As the ice melts, the level of the sea may fall. |
| TRUE | FALSE | d) Language can be used to describe regions in Antarctica. |
| TRUE | FALSE | e) Mt. Erebus is on the Ross Ice Shelf. |
| TRUE | FALSE | f) Geographers are very interested in the changes happening in Antarctica. |
| TRUE | FALSE | g) Mt. Erebus is 1 200 feet tall. |
| TRUE | FALSE | h) There is hot lava in Mt. Erebus' cone. |

1.

Color/highlight:
ice shelves
mountains
volcano
pack ice
Ross Sea
climate change

3.

Snow covered, looks like a mountain, lava in cone, steam rises each day, on Ross Island

4.

Mountains would appear taller, islands would appear, a cold barren landscape would be visible

5.

Answers will vary depending upon resources used

6.

- a) Queen of Norway / Roald Amundsen / pre-1930
- b) Enderby Bros. / John Biscoe / 1831
- c) Prince Charles / US Navy / 1946
- d) George V's wife / Australia Antarctic Exped. / 1912
- e) Charles Wilkes / Charles Wilkes / 1838
- f) Queen Victoria / --- / ---
- g) James Ross / James Ross / 1841
- h) Sir William Beardmore / Ernest Shackleton / 1908
- i) Admiral Byrd's wife / --- / ---
- j) James Coats / William Bruce / 1902
- k) Princess Martha of Norway / Hjalmar Riiser-Larsen / 1930

Answers will vary in detail depending upon choices and resources used.

2.

- a) T
- b) T
- c) F
- d) F
- e) F
- f) T
- g) F
- h) T

9

10

12

Across:

- 1. southern
- 4. snowmobiles
- 8. Equator
- 9. icebergs
- 12. continent
- 14. desert
- 15. South America
- 16. uninhabited
- 17. movement

Down:

- 1. scientists
- 2. South Pole
- 3. difficult
- 5. ozone
- 6. global warming
- 7. penguins
- 10. Icebreaker
- 11. longitude
- 13. climate



EASY MARKING ANSWER KEY